

RPORI 32

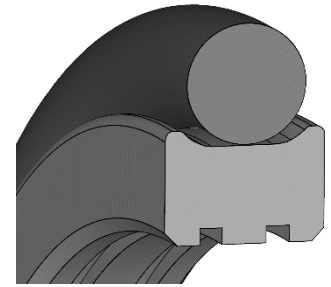

DESCRIPTION

Construction group: R radial seal

Construction form: PORI PTFE seal with O-Ring pretensioning element, internal sealing

Profile no.: 32

Specification: Z pressure load applied at both sides

Seal material: PTFE 00

O-ring material: NBR 70

OPERATIONAL APPLICATION LIMITS

Pressure (MPa): ≤ 30

Temperature (°C): -30 to $+120$

Peripheral speed (m/s): ≤ 2

MEDIA

- Hydraulic oils as per DIN 51524 Part 1 – 3
- lubricating oils
- mineral oil based lubricants and greases
- non-flammable hydraulic pressure fluids HFA, HFB, HFC as per VDMA 24317
- Water
- water-oil emulsion

FUNCTION

The RPORI 32 is a twin-action seal consisting of a PTFE sealing element pretensioned by an O-ring. The seal is internally sealing and is normally used in a twin arrangement. The sealing surface is specially designed for use under high pressures and at low speeds. The grooves running round the dynamic sealing surface offer the possibility of creating a deposit of lubricant. This has the effect of reducing friction and enhancing emergency running properties.

APPLICATION

The RPORI 32 is used for sealing hydraulic rotary transmission leadthroughs and to seal swivelling or rotating shafts/rods.

INSTALLATION

For smaller diameters, the seal requires an installation housing offering axial access. For larger diameters, seals can be installed in an enclosed installation housing. Calibration is then required.

