

WIPER AE 42

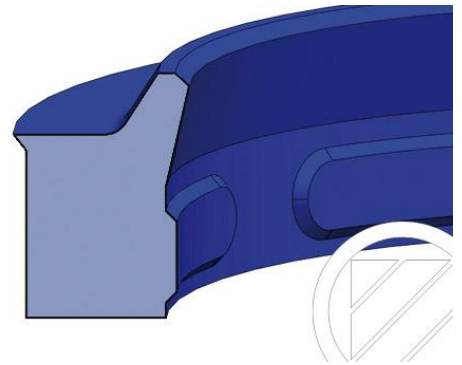

DESCRIPTION

Product group: Wiper
Design: E single-acting
Profile no.: 42
Material: TPU 90

OPERATIONAL APPLICATION LIMITS

Temperature (°C): -40 to +100
Running speed (m/s): ≤ 2

MEDIA

- Hydraulic oils acc. to DIN 51524 Part 1 – 3
- Lubricating oils
- Mineral oil based lubricating greases
- Highly non-flammable hydraulic fluids HFA, HFB, HFC acc. to VDMA 24317

FUNCTION

The AE 42 is a single-acting wiper. Because it is pressed against the rod, dirt is wiped from the surface by the action of the rod as it retracts.

INSTALLATION

The wiper is installed in a semi-closed axial groove.

REMARKS

Wipers made of TPU are particularly well suited to applications in mobile hydraulics where they are subjected to a heavy dirt load. Due to the good wear resistance of polyurethane, the AE 42 has a particularly long service life. AE 42 standard dimensions have pads on the inner diameter which support the correct functional fit.

